

ARUM DIGITAL SOLUTIONS 2023-24



INDEX

About us	3
ARUM Digital Dentistry Workflow	4-5
ARUM Milling Machine Line-up	6-7
5X-200	8-11
5X-500	12-15
5X-500L	16-19
5X-450	20-23
5X-300Pro	24-27
5X-300D	28-29
CAM Program [ApexMill]	30-33
ARUM 3D Printer System [3D Printer & UV curing & Resin]	34-35
Zirconia Block [ARENA]	36-37
CAD/CAM etc.	38-39
Consumables	40-51
Intraoral Scanbody	40
Model Scanbody & Screw	41
Pre-milled Blank & Attachment & AT Wrech	42-43
Ti-Base & Analog	44
Lab Driver [iPen]	45-46
Clinical Driver	47
Consumable Line-up	48-51

The Leading Company in Digital Dentistry. ARUM DENTISTRY

Founded in 2000 as a leader in the digital dentistry solution, ARUM DENTISTRY has been providing Digital Total Solution for prosthetic treatment based on a digital prosthesis production solution (Dental CAD/CAM milling machine, dental materials) such as 3D Printer System (Metal, LCD, DLP, Resin, UV curing machine, etc.), Zirconia Block Implant and CAM Software, thereby leading the digital dentistry market.

ARUM DENTISTRY has invigorated the patent-customized abutment by utilizing industry's first pre-milled blank machining. With the worldwide CAD/CAM processing machining cases accumulated over the last 20 years, ARUM DENTISTRY has built the world's largest library & dental material line-up and is expanding the line-up through continuous product development.

ARUM DENTISTRY is building its unrivalled competitiveness through the meticulous inspection of all products, continued efforts to acquire international licenses (KGMP, FDA, CE, NMPA, PMDA), and customer support and A/S within 24 hours with the aim of realizing the highest-level quality management.

Taking the lead in innovating the world's most differentiated technologies, ARUM DENTISTRY has been exporting its products to more than 70 countries, earning recognition from users around the world for its technology. ARUM DENTISTRY is advancing towards Digital Dentistry Innovation by constantly listening to the voices of customers and endeavouring to research and develop advanced technologies.

ARUM Digital Dentistry Workflow

With use of products of ARUM DENTISTRY from planning & treatment and CAD/CAM design to prosthesis production, Digital Dentistry becomes fun for you.

You can realize simple prosthesis production and prosthetic treatment using ARUM Digital Dentistry Solution that features: "Fixture Design (Patent No. 10-2118038)" allowing rapid formation of new bones by the distribution of the stress on the upper part of the fixture to prevent fracture and facilitate smooth blood flow in the screw part (Patent No.

10-2118038); "Excellent Machining Precision of CAD / CAM milling machine recognized in the world market over the last 20 years; "Accurate and Excellent Quality Dental Material" that went through total inspection process (Ti 6Al-4V ELI / stainless steel 303F); "Zirconia Block" boasting its strength and natural shade, and "3D Printer System"(Printer, UV curing machine, Resin) boasting its fast printing speed and accuracy, you can realize simple prosthesis production and prosthetic treatment.

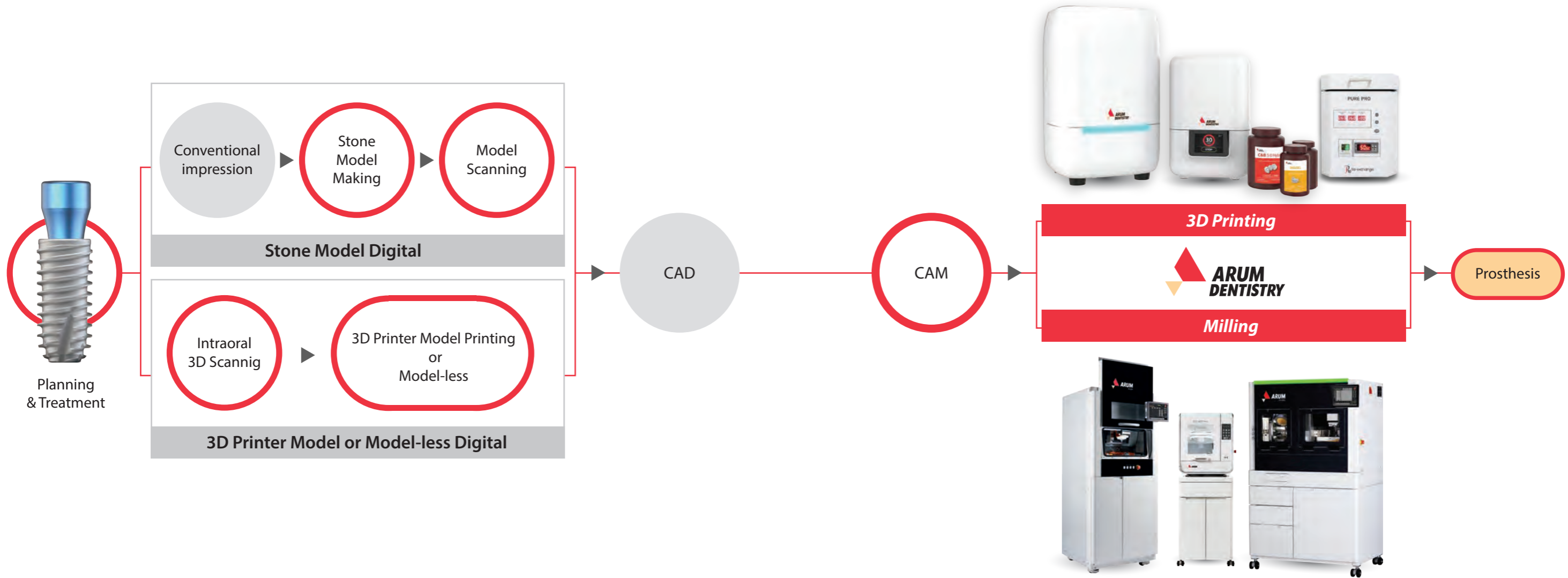

NB System

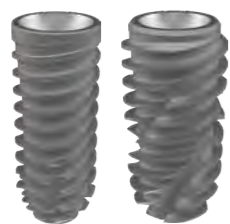

Implant Surgical Kit



Consumables



F1 Plasma



Milling Machine



ApexMill



ARENA & ARENA Star



Resin & 3D Printer & UV Curing Machine



ARUM Milling Machine Line-up

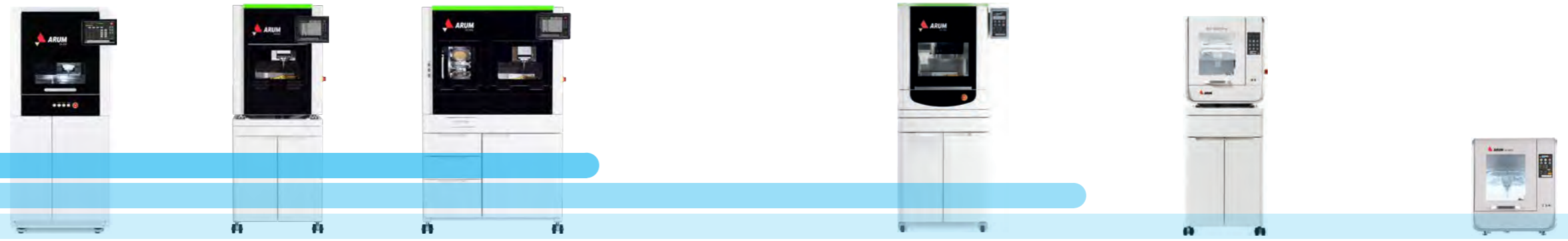

Metal Disk (Co-Cr)

Pre-milled Blank

Zirconia Block

Model	5X-200	5X-500	5X-500L
Axis	5 Axis	5 Axis	5 Axis
Processing	Wet and Dry	Wet and Dry	Wet and Dry
Max. RPM	60,000	60,000	60,000
Spindle Power	DC 3.0kw	AC 2.2kw	AC 2.2kw
A.T.C	15	20	20
Tool Shank (mm)	Ø6	Ø6	Ø6
Motor	Servo	Servo	Servo
Drive Mechanism	Ball Screw	Ball Screw	Ball Screw
Way System	Linear Guide	Linear Guide	Linear Guide
Total Size (W*D*H)	800*950*1760mm	710*910*1695mm	1100*910*1735mm
Weight (Machine / Table)	270kg / 135kg	230kg / 65kg	330kg / 110kg
Travel	X,Y,Z axis	330*146*145mm	228*128*130mm
	A / B axis	360° / ±30°	360° / ±30°
Disk Jig or Cartridge Type	O type	O type, C type	O type, C type
Number of Jig	-	-	12
Jig exchange	-	-	Auto
Materials			
Pre-milled Blank (Titanium)	◎ (5ea)	◎ (10ea)	◎ (10ea)
Co-Cr & Ni-Cr Disk	◎	○	○
Titanium Disk	◎	◎	◎
Lithium Disilicate	○	○	○
Nanocomposite	◎	◎	◎
Zirconia	◎	◎	◎
PMMA	◎	◎	◎
PEEK	◎	◎	◎
Wax	◎	◎	◎
Applications			
Implant Bar	◎	◎	◎
Screw-Retained Bridge	◎	◎	◎
Customized Abutment	◎	◎	◎
Hybrid Abutment	◎	◎	◎
Inlay & Onlay	◎	◎	◎
Crown & Coping	◎	◎	◎
Crown & Coping Bridge	◎	◎	◎
Model	◎	◎	◎
Bite Splint	◎	◎	◎
Denture	◎	◎	◎
Page	8-11p	12-15p	16-19p

Model	5X-450	5X-300 Pro	5X-300 D
Axis	5 Axis	5 Axis	5 Axis
Processing	Wet and Dry	Wet and Dry	Dry
Max. RPM	60,000	80,000	60,000
Spindle Power	AC 1.28kw	AC 0.5kw	AC 0.5kw
A.T.C	15	12	12
Tool Shank (mm)	Ø6	Ø4	Ø4
Motor	Stepping	Stepping	Stepping
Drive Mechanism	Ball Screw	Ball Screw	Ball Screw
Way System	Linear Guide	Linear Guide	Linear Guide
Total Size (W*D*H)	790*790*1645mm	570*620*1580mm	570*620*640mm
Weight (Machine / Table)	185kg / 65kg	90kg / 65kg	90kg / -
Travel	X,Y,Z axis	245*116*130mm	159*120*90mm
	A / B axis	360° / ±35°	±30° / 360°
Disk Jig or Cartridge Type	C type	C type	C type
Number of Jig	-	-	-
Jig exchange	-	-	-
Materials			
Pre-milled Blank (Titanium)	◎ (5ea)	X	X
Co-Cr & Ni-Cr Disk	X	X	X
Titanium Disk	○	X	X
Lithium Disilicate	○	◎	X
Nanocomposite	◎	◎	◎
Zirconia	◎	◎	◎
PMMA	◎	◎	◎
PEEK	◎	◎	◎
Wax	◎	◎	◎
Applications			
Implant Bar	◎	X	X
Screw-Retained Bridge	◎	X	X
Customized Abutment	◎	X	X
Hybrid Abutment	◎	◎	◎
Inlay & Onlay	◎	◎	◎
Crown & Coping	◎	◎	◎
Crown & Coping Bridge	◎	◎	◎
Model	◎	◎	◎
Bite Splint	◎	◎	◎
Denture	◎	◎	◎
Page	20-23p	24-27p	28-29p

* Products are subject to change without notice to improve quality, function, design or otherwise. / ◎: High Compatibility / ○: Compatibility / X: Non-Compatibility

ARUM 5X-200 Complete Ultimate System



- Co-Cr
- Ni-Cr
- Titanium
- PMMA
- Zirconia
- Resin
- Wax
- Customized Abutment



A standard of METAL milling

This machine can be compared with none of the metal milling machine. You can mill various shapes such as Implant Bar Bridge, Screw-retain Bridge, and Partial Framework using various materials such as Titanium, Co-Cr, and Ni-Cr, etc.

Based on unsurpassed metal milling capability and extensive know-how accumulated over many years, the excellence of our product has been proven in the global market.



Mounting of 5 pre-milled blanks

With a function of mounting of 5 pre-milled blanks simultaneously. Also, you can product Customized Abutment without Connector with AT Holder. In addition, it is possible to process using the Straumann PMAB holder (Bushing type) exclusively for Straumann Pre-milled Blanks, so it has expandability.



Amazing milling power

With DC 3.0kw spindle, Servo Motor & Linear Guide, you can mill any dental material such as Titanium, Co-Cr, Pre-milled Blank, Zirconia, Lithium Disilicate, Nanocomposite, PMMA, PEEK, and WAX and more.



Special tool designed for perfection

The optimal tool designed to increase the completeness of milling. With use of ARUM's special tools such as Drill Tool, Reamer Tool, and Thread Tool, etc., you can achieve the best milling restoration.

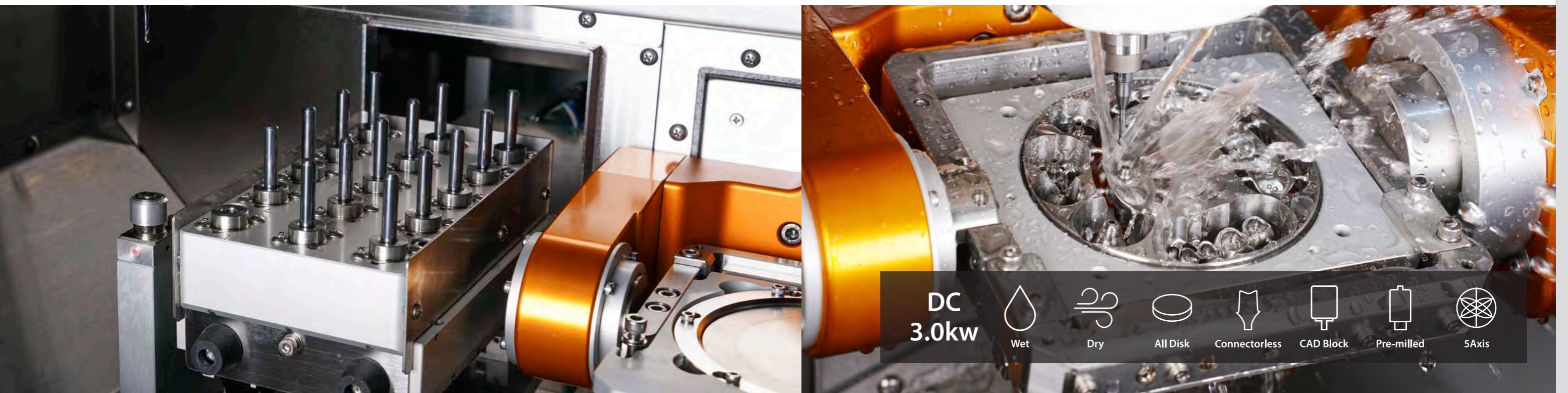

- DC 3.0kw
- Wet
- Dry
- All Disk
- Connectorless
- CAD Block
- Pre-milled
- 5Axis

Screw-Retained Bridge Crown & Coping

Co-Cr & Titanium Disk

Implant Bar & Screw-Retained Bridge Coping



Materials & Applications Info.

Materials		Applications	
Pre-milled Blank (Titanium)	◎ (5ea)	Implant Bar	◎
Co-Cr & Ni-Cr Disk	◎	Screw-Retained Bridge (Crown & Coping)	◎
Titanium Disk	◎	Customized Abutment	◎
Lithium Disilicate	○	Hybrid Abutment	◎
Nanocomposite	◎	Inlay & Onlay	◎
Zirconia	◎	Crown & Coping	◎
PMMA	◎	Crown & Coping Bridge	◎
PEEK	◎	Model	◎
Wax	◎	Bite Splint	◎
		Denture	◎

◎: High Compatibility / ○: Compatibility / X: Non-Compatibility

Specifications

Axis	5-Axis	Drive Mechanism	Ball Screw
Processing	Wet and Dry	Way System	Linear Guide
Spindle Power	DC 3.0kw	Machine Size (W*D*H)	800*950*940mm
Max. RPM	60,000	Total Size (W*D*H)	800*950*1760mm
A.T.C	15	Weight (Machine / Table)	270kg / 135kg
Tool Shank (mm)	Ø6	Travel	X,Y,Z axis
Motor	Servo		A / B axis
			330*146*145mm
			360° / ±30°

Tool List

Basic	Code	Size	Code	Size	Code	Size
	ZB-05	D2.0*L20*55	MB-14	D0.6*L03*50	MF-15	D2.0*L18*55
	ZB-06	D1.0*L14*53	MD-18	D1.5*L14*50	MF-45	D1.5*L07*50
	ZB-07	D0.6*L08*50	MD-19	D2.0*L18*55	MF-71	D0.6*L05*50
	MB-09	D3.0*L12*50	DG-21	D1.0*L10*50	MFR-44	D1.5*L05*R0.1*50
	MB-10	D2.0*L12*50	DG-22	D0.6*L08*50	MFR-66	D1.5*L14*50
	MB-11	D1.5*L10*50	DG-37	D2.5*L12*50	MTR-72	M2*P0.4
	MB-12	D1.0*L10*50	DG-38	D1.5*L10*50		
Special	Code	Size	Code	Size	Code	Size
	ZB-01	D2.0*L20*63(Dia)	TC-83	D1.8*L08*50	MR-06	D2.3*L18*55*90°
	ZB-01A	D2.0*L20*63(DLC)	TC-84	D1.5*L08*50	MR-07	D2.3*L18*55*30°
	ZB-02	D1.0*L16*63(Dia)	MD-73	D1.1*L05*50	MR-09	D2.4*L18*55*70°
	ZB-02A	D1.0*L16*63(DLC)	MFR-43	D2.0*L18*R0.2*55	MR-10	D2.6*L18*55*30°
	ZB-03	D0.6*L13*63	MFR_66	D1.5*L14*50	MR-11	D2.4*L18*55*140°
	ZB-04	D0.3*L1.5*63	MTR-74	M1.4*P0.3	MR-12	D2.6*L18*55*90°
	ZB_08	D0.5*L08*50*6°	TH-69	M2.0*P0.4	MR-13	D2.7*L18*55*70°
	ZB-77	D3.0*L20*50	TH-70	M1.4*P0.3	MR-14	D2.3*L18*55*70°
	ZB-78	D0.3*L1.5*50	MR-01	D3.5*L18*55*180°	MR-15	D2.3*L18*55*180°
	MB-67	D1.5*L16*52	MR-02	D2.6*L18*55*180°	MR-16	D2.4*L18*55*90°
	TC-82	D2.0*L08*50	MR-05	D2.3*L18*55*120°		

Accessories

				
Disk Cartridge	AT Holder	Attachment	Bushing	Straumann PMAB holder

* Products are subject to change without notice to improve quality, function, design or otherwise.

ARUM 5X-500

The Leader of Middle Class Specialized



- | | |
|---------------------|----------|
| Customized Abutment | Titanium |
| Ni-Cr | Co-Cr |
| PMMA | Zirconia |
| Resin | Wax |



Outstanding machining performance

5X-500 is a modal without a loader part. With it you can easily replace 4 types of jigs, which allows you to be able to freely machine from disk to pre-milled blank.

Excellent Precision and Durability

With ZERO Point system, you can achieve excellent origin point precision despite repeated jig replacement, which allows you to machine even complex shape stably. Servo Motor with built-in Absolute Encoder and Auxiliary Support compensates for even fine vibrations.



Best-in-class Spindle

With the powerful spindle from Sycotec in Germany, it boasts excellent performance in machining all dental CAD/CAM materials including metal (Co-Cr, Titanium, Ni-Cr)



Labial Side Machining

With Open C Type Jig, you can minimize time spent in precision machining and post-machining of labial (or Buccal) side texture and undercut area.

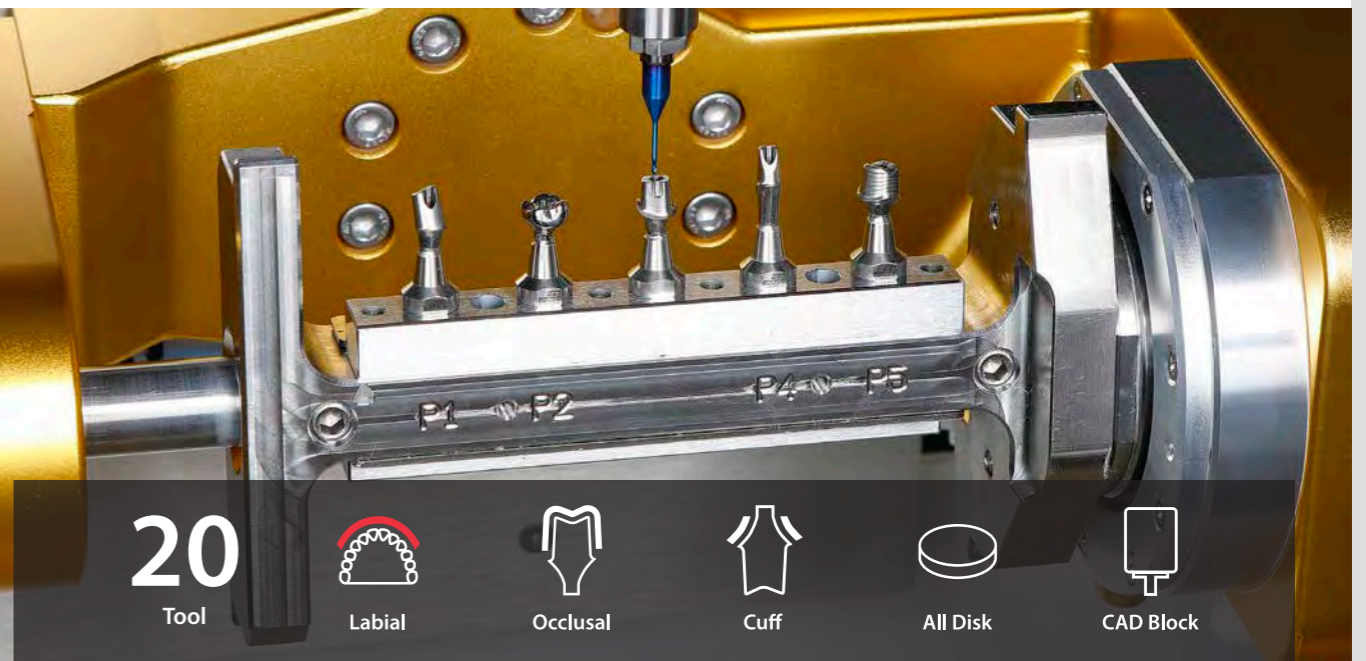
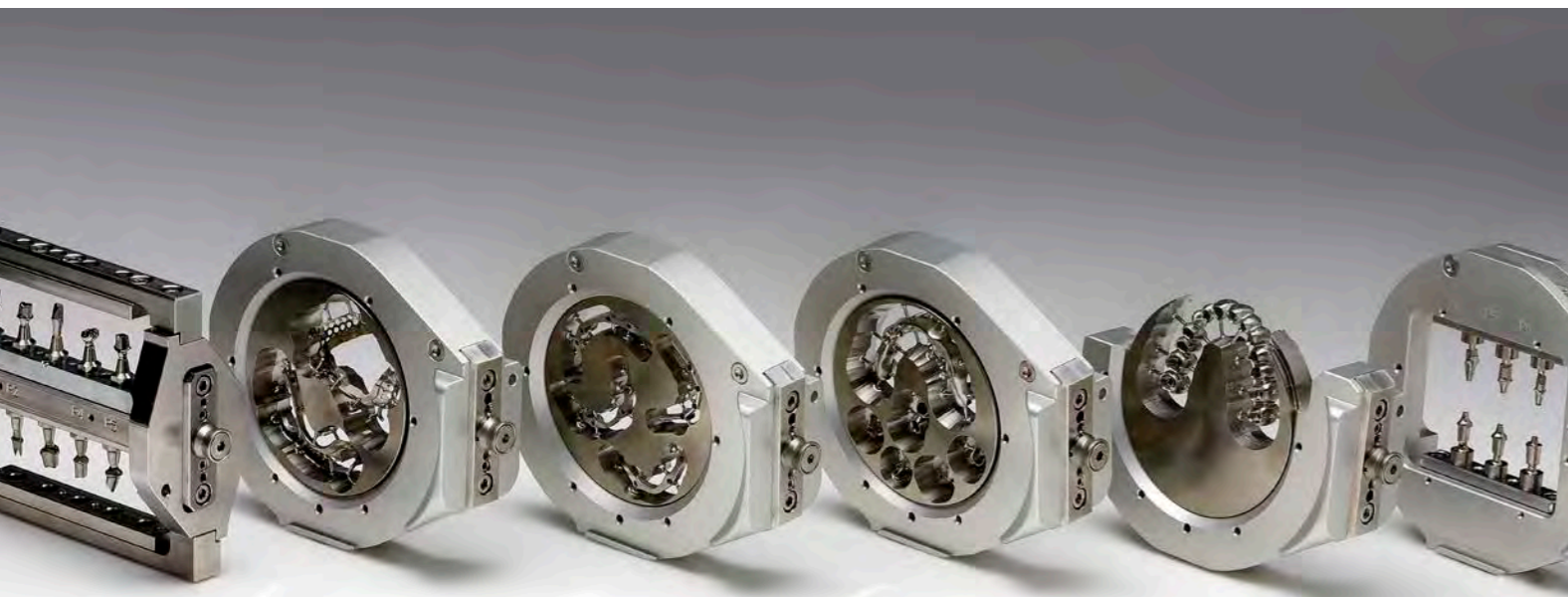
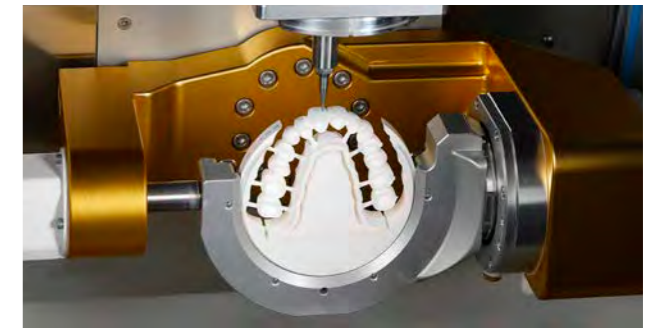

20

Tool



Labial



Occlusal



Cuff



All Disk



CAD Block

Materials & Applications Info.

Materials		Applications	
Pre-milled Blank (Titanium)	◎ (10ea)	Implant Bar	◎
Co-Cr & Ni-Cr Disk	○	Screw-Retained Bridge (Crown & Coping)	◎
Titanium Disk	◎	Customized Abutment	◎
Lithium Disilicate	○	Hybrid Abutment	◎
Nanocomposite	◎	Inlay & Onlay	◎
Zirconia	◎	Crown & Coping	◎
PMMA	◎	Crown & Coping Bridge	◎
PEEK	◎	Model	◎
Wax	◎	Bite Splint	◎
		Denture	◎

◎: High Compatibility / ○: Compatibility / X: Non-Compatibility

Tool List

	Code	Size	Code	Size	Code	Size
Basic	ZB-05	D2.0*L20*55	MB-14	D0.6*L03*50	MF-15	D2.0*L18*55
	ZB-06	D1.0*L14*53	MD-18	D1.5*L14*50	MF-45	D1.5*L07*50
	ZB-07	D0.6*L08*50	MD-19	D2.0*L18*55	MF-71	D0.6*L05*50
	MB-09	D3.0*L12*50	DG-21	D1.0*L10*50	MFR-44	D1.5*L05*R0.1*50
	MB-10	D2.0*L12*50	DG-22	D0.6*L08*50	MFR-66	D1.5*L14*50
	MB-11	D1.5*L10*50	DG-37	D2.5*L12*50	MTR-72	M2*P0.4
	MB-12	D1.0*L10*50	DG-38	D1.5*L10*50		
Special	ZB-01	D2.0*L20*63(Dia)	TC-83	D1.8*L08*50	MR-06	D2.3*L18*55*90°
	ZB-01A	D2.0*L20*63(DLC)	TC-84	D1.5*L08*50	MR-07	D2.3*L18*55*30°
	ZB-02	D1.0*L16*63(Dia)	MD-73	D1.1*L05*50	MR-09	D2.4*L18*55*70°
	ZB-02A	D1.0*L16*63(DLC)	MFR-43	D2.0*L18*R0.2*55	MR-10	D2.6*L18*55*30°
	ZB-03	D0.6*L13*63	MFR_66	D1.5*L14*50	MR-11	D2.4*L18*55*140°
	ZB-04	D0.3*L1.5*63	MTR-74	M1.4*P0.3	MR-12	D2.6*L18*55*90°
	ZB_08	D0.5*L08*50*6°	TH-69	M2.0*P0.4	MR-13	D2.7*L18*55*70°
	ZB-77	D3.0*L20*50	TH-70	M1.4*P0.3	MR-14	D2.3*L18*55*70°
	ZB-78	D0.3*L1.5*50	MR-01	D3.5*L18*55*180°	MR-15	D2.3*L18*55*180°
	MB-67	D1.5*L16*52	MR-02	D2.6*L18*55*180°	MR-16	D2.4*L18*55*90°
	TC-82	D2.0*L08*50	MR-05	D2.3*L18*55*120°		

Specifications

Axis	5-Axis	Drive Mechanism	Ball Screw
Processing	Wet and Dry	Way System	Linear Guide
Spindle Power	AC 2.2kw	Machine Size (W*D*H)	710*910*840mm
Max. RPM	60,000	Total Size (W*D*H)	710*910*1735mm
A.T.C	20	Weight (Machine / Table)	230kg / 65kg
Tool Shank (mm)	Ø6	Travel	X,Y,Z axis
Motor	Servo		A / B axis
			228*128*130mm
			360° / ±30°

Accessories

			
Premill Jig T Type	Disk Jig	Disk C Type Jig	
			
CAD Block Cartridge	Attachment	Calibration Master & Probe	Straumann PMAB holder

* Products are subject to change without notice to improve quality, function, design or otherwise.

ARUM 5X-500L

The Leader of Middle Class Specialized



- Loader Auto Change 12 Jig
- Customized Abutment
- Titanium
- Ni-Cr
- Co-Cr
- PMMA
- Zirconia
- Resin
- Wax

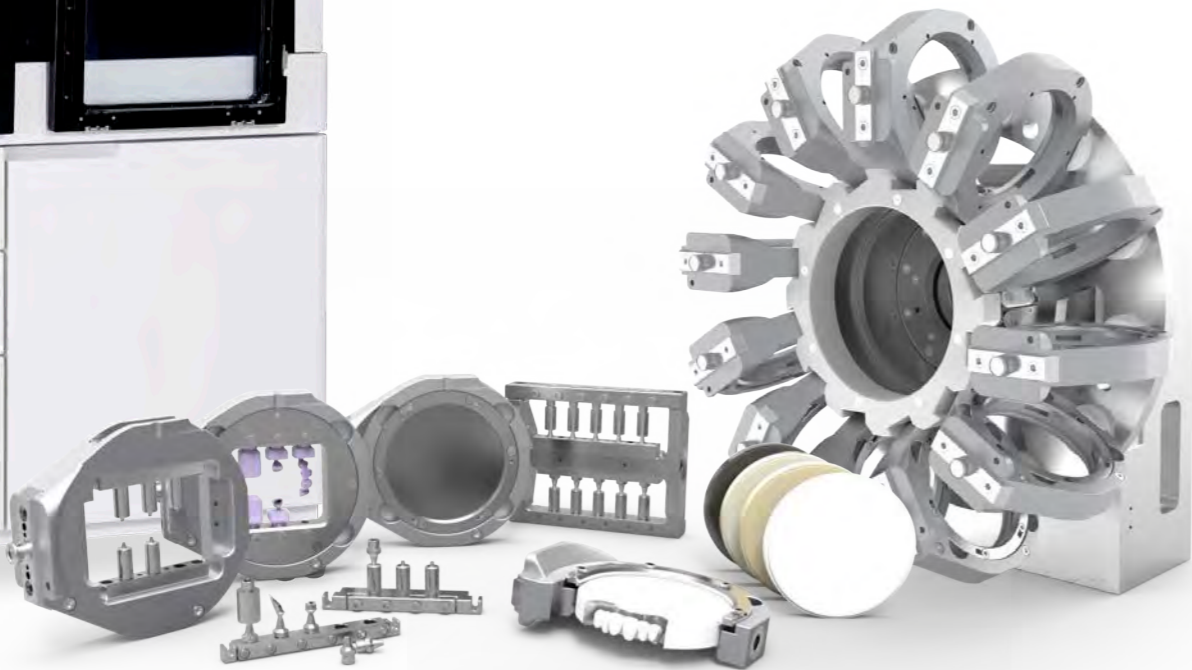

Excellent Precision and Durability

With ZERO Point system, you can achieve excellent origin point precision despite repeated jig replacement, which allows you to machine even complex shape stably. Servo Motor with built-in Absolute Encoder and Auxiliary Support compensates for even fine vibrations.



Best-in-class Spindle

With the powerful spindle from Sycotec in Germany, it boasts excellent performance in machining all dental CAD/CAM materials including metal (Co-Cr, Titanium, Ni-Cr).

Labial Side Machining

With Open C Type Jig, you can minimize time spent in precision machining and post-machining of labial (or Buccal) side texture and undercut area.

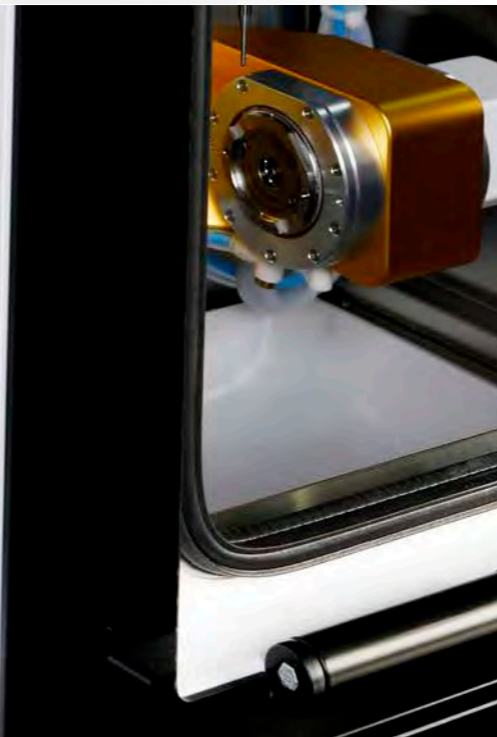
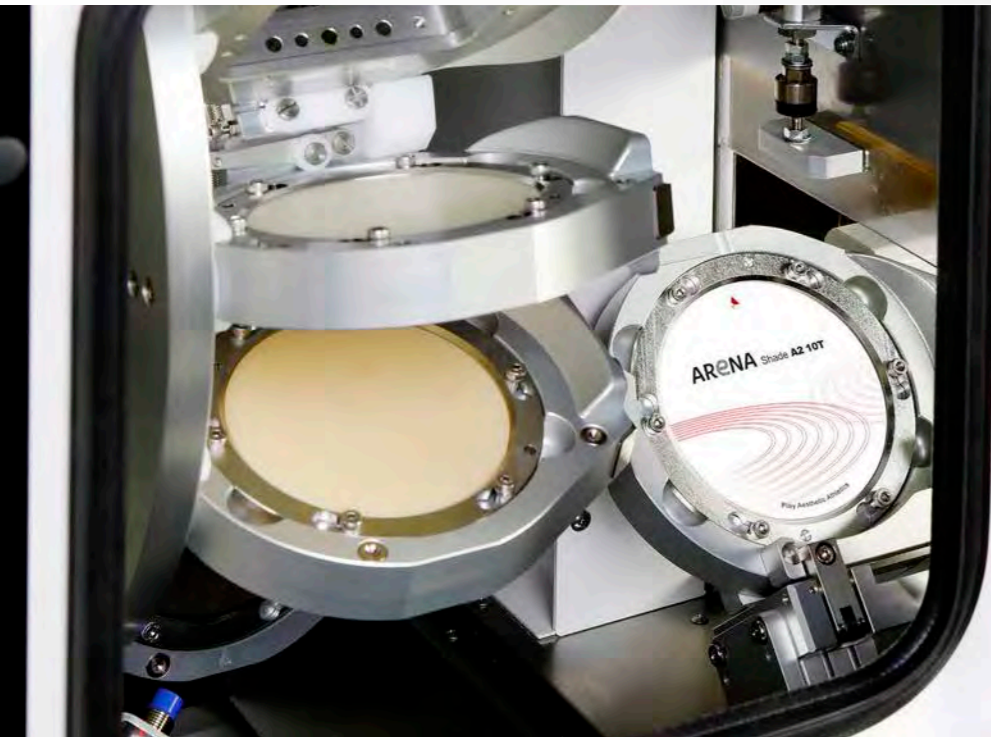
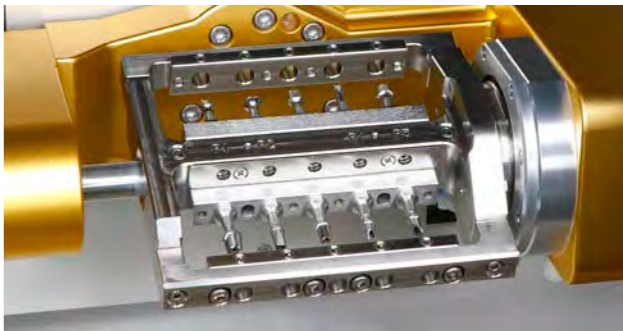

12 Magazine

20 Tool

Labial

Occlusal

Cuff

All Disk

CAD Block

Materials & Applications Info.

Materials		Applications	
Pre-milled Blank (Titanium)	◎ (10ea)	Implant Bar	◎
Co-Cr & Ni-Cr Disk	○	Screw-Retained Bridge (Crown & Coping)	◎
Titanium Disk	◎	Customized Abutment	◎
Lithium Disilicate	○	Hybrid Abutment	◎
Nanocomposite	◎	Inlay & Onlay	◎
Zirconia	◎	Crown & Coping	◎
PMMA	◎	Crown & Coping Bridge	◎
PEEK	◎	Model	◎
Wax	◎	Bite Splint	◎
		Denture	◎

◎: High Compatibility / ○: Compatibility / X: Non-Compatibility







Tool List

	Code	Size	Code	Size	Code	Size
	Basic	ZB-05	D2.0*L20*55	MB-14	D0.6*L03*50	MF-15
ZB-06		D1.0*L14*53	MD-18	D1.5*L14*50	MF-45	D1.5*L07*50
ZB-07		D0.6*L08*50	MD-19	D2.0*L18*55	MF-71	D0.6*L05*50
MB-09		D3.0*L12*50	DG-21	D1.0*L10*50	MFR-44	D1.5*L05*R0.1*50
MB-10		D2.0*L12*50	DG-22	D0.6*L08*50	MFR-66	D1.5*L14*50
MB-11		D1.5*L10*50	DG-37	D2.5*L12*50	MTR-72	M2*P0.4
MB-12		D1.0*L10*50	DG-38	D1.5*L10*50		
Special	Code	Size	Code	Size	Code	Size
	ZB-01	D2.0*L20*63(Dia)	TC-83	D1.8*L08*50	MR-06	D2.3*L18*55*90°
	ZB-01A	D2.0*L20*63(DLC)	TC-84	D1.5*L08*50	MR-07	D2.3*L18*55*30°
	ZB-02	D1.0*L16*63(Dia)	MD-73	D1.1*L05*50	MR-09	D2.4*L18*55*70°
	ZB-02A	D1.0*L16*63(DLC)	MFR-43	D2.0*L18*R0.2*55	MR-10	D2.6*L18*55*30°
	ZB-03	D0.6*L13*63	MFR_66	D1.5*L14*50	MR-11	D2.4*L18*55*140°
	ZB-04	D0.3*L1.5*63	MTR-74	M1.4*P0.3	MR-12	D2.6*L18*55*90°
	ZB_08	D0.5*L08*50*6°	TH-69	M2.0*P0.4	MR-13	D2.7*L18*55*70°
	ZB-77	D3.0*L20*50	TH-70	M1.4*P0.3	MR-14	D2.3*L18*55*70°
	ZB-78	D0.3*L1.5*50	MR-01	D3.5*L18*55*180°	MR-15	D2.3*L18*55*180°
	MB-67	D1.5*L16*52	MR-02	D2.6*L18*55*180°	MR-16	D2.4*L18*55*90°
	TC-82	D2.0*L08*50	MR-05	D2.3*L18*55*120°		

Specifications

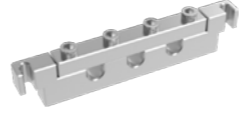
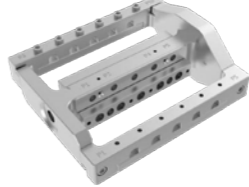
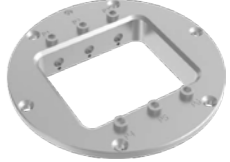
Axis	5-Axis	Way System	Linear Guide	
Processing	Wet and Dry	Machine Size (W*D*H)	710*910*840mm	
Spindle Power	AC 2.2kw	Total Size (W*D*H)	710*910*1735mm	
Max. RPM	60,000	Weight (Machine / Table)	330kg / 110kg	
A.T.C	20	Travel	X,Y,Z axis	228*128*130mm
Tool Shank (mm)	Ø6		A / B axis	360° / ±30°
Motor	Servo	Number of Jig	12	
Drive Mechanism	Ball Screw	Jig exchange	Auto	

Accessories

		
Disk Jig	Disk C Type Jig	Premill Jig
		
AT Holder	Premill Jig T Type	CAD Block Cartridge
		
Attachment	Calibration Master & Probe	Straumann PMAB holder

* Products are subject to change without notice to improve quality, function, design or otherwise.



ARUM 5X-450

Faithful Mill for Main Prosthesis



Customized Abutment

Zirconia

PMMA

Resin



Milling of various prostheses

With use of open C type cartridge, you can precisely machine Labial Side (Buccal Side) and Under-Cut zone that requires additional machining. With the amazing power of the best-in-class spindle AC 1.28kw, you can machine various shapes and materials such as Denture, Zirconia, CAD Block, and Titanium milled Bar. etc.

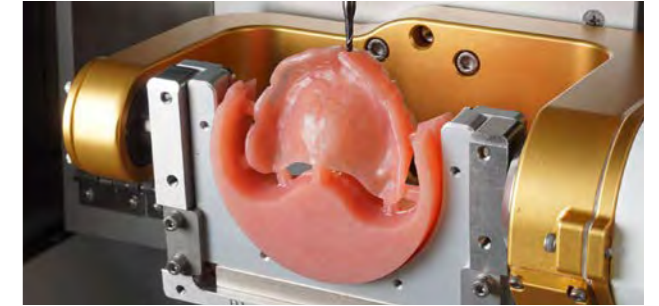





C-Type Cartridge

With use of open C type cartridge, you can precisely machine Labial Side (Buccal Side) and Under-Cut zone that requires additional machining.

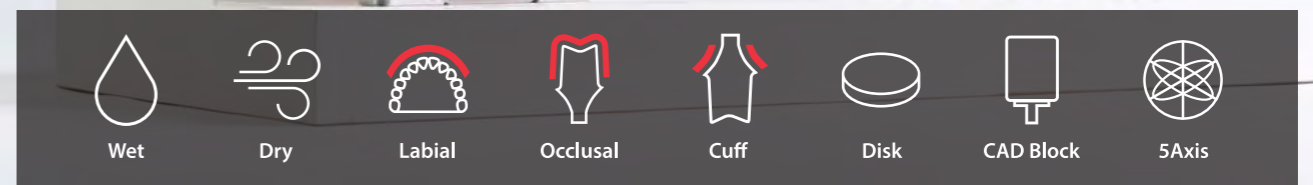
Excellent Precision Using AT Cartridge

Differentiated round bar machining
 You can machine Cuff Side (Gingival area), Occlusal Side, Connectorless, and Retention Groove in simple Top & Bottom Side milling using AT cartridge.



- 
 Wet
- 
 Dry
- 
 Labial
- 
 Occlusal
- 
 Cuff
- 
 Disk
- 
 CAD Block
- 
 5Axis

Titanium Disk



Zirconia Crown



Materials & Applications Info.

Materials		Applications	
Pre-milled Blank (Titanium)	◎ (5ea)	Implant Bar	◎
Co-Cr & Ni-Cr Disk	X	Screw-Retained Bridge (Crown & Coping)	◎
Titanium Disk	○	Customized Abutment	◎
Lithium Disilicate	○	Hybrid Abutment	◎
Nanocomposite	◎	Inlay & Onlay	◎
Zirconia	◎	Crown & Coping	◎
PMMA	◎	Crown & Coping Bridge	◎
PEEK	◎	Model	◎
Wax	◎	Bite Splint	◎
		Denture	◎

◎: High Compatibility / ○: Compatibility / X: Non-Compatibility

Accessories

Disk Cartridge (C-Type)	AT Holder	AT Cartridge
CAD Block Cartridge	Attachment	Straumann PMAB holder

Specifications

Axis	5-Axis	Drive Mechanism	Ball Screw
Processing	Wet and Dry	Way System	Linear Guide
Spindle Power	AC 1.28kw	Machine Size (W*D*H)	790*790*790mm
Max. RPM	60,000	Total Size (W*D*H)	790*790*1645mm
A.T.C	15	Weight (Machine / Table)	185kg / 65kg
Tool Shank (mm)	Ø6	Travel	X,Y,Z axis
Motor	Stepping		A / B axis
			245*116*130mm
			360° / ±35°

Tool List

	Code	Size	Code	Size	Code	Size
	Basic	ZB-05	D2.0*L20*55	MB-14	D0.6*L03*50	MF-15
ZB-06		D1.0*L14*53	MD-18	D1.5*L14*50	MF-45	D1.5*L07*50
ZB-07		D0.6*L08*50	MD-19	D2.0*L18*55	MF-71	D0.6*L05*50
MB-09		D3.0*L12*50	DG-21	D1.0*L10*50	MFR-44	D1.5*L05*R0.1*50
MB-10		D2.0*L12*50	DG-22	D0.6*L08*50	MFR-66	D1.5*L14*50
MB-11		D1.5*L10*50	DG-37	D2.5*L12*50	MTR-72	M2*P0.4
MB-12		D1.0*L10*50	DG-38	D1.5*L10*50		
Special	Code	Size	Code	Size	Code	Size
	ZB-01	D2.0*L20*63(Dia)	TC-83	D1.8*L08*50	MR-06	D2.3*L18*55*90°
	ZB-01A	D2.0*L20*63(DLC)	TC-84	D1.5*L08*50	MR-07	D2.3*L18*55*30°
	ZB-02	D1.0*L16*63(Dia)	MD-73	D1.1*L05*50	MR-09	D2.4*L18*55*70°
	ZB-02A	D1.0*L16*63(DLC)	MFR-43	D2.0*L18*R0.2*55	MR-10	D2.6*L18*55*30°
	ZB-03	D0.6*L13*63	MFR_66	D1.5*L14*50	MR-11	D2.4*L18*55*140°
	ZB-04	D0.3*L1.5*63	MTR-74	M1.4*P0.3	MR-12	D2.6*L18*55*90°
	ZB_08	D0.5*L08*50*6°	TH-69	M2.0*P0.4	MR-13	D2.7*L18*55*70°
	ZB-77	D3.0*L20*50	TH-70	M1.4*P0.3	MR-14	D2.3*L18*55*70°
	ZB-78	D0.3*L1.5*50	MR-01	D3.5*L18*55*180°	MR-15	D2.3*L18*55*180°
	MB-67	D1.5*L16*52	MR-02	D2.6*L18*55*180°	MR-16	D2.4*L18*55*90°
	TC-82	D2.0*L08*50	MR-05	D2.3*L18*55*120°		

* Products are subject to change without notice to improve quality, function, design or otherwise.

ARUM 5X-300 Pro Bright Future, Right System



- Zirconia
- PMMA
- Resin
- Wax
- Ceramic Glass



Efficient C-TYPE JIG

Labial (or Buccal) side texture and undercut area precision processing minimize post-processing time.

Easy and easy material change

You can easily exchange from disk to CAD block as it uses cartridge type materials.



All in One System

An external compressor is not required, and all additional devices (Dust Collector, Coolant System) are built inside the table to overcome installation space constraint and minimize noise. ** German Renfert SILENT compact CAM model is used (optional)

High speed 80,000 RPM

By choosing one from 2 modes of roughing process (U peeling milling, and Parallel milling), you can process glass ceramic materials more effectively.

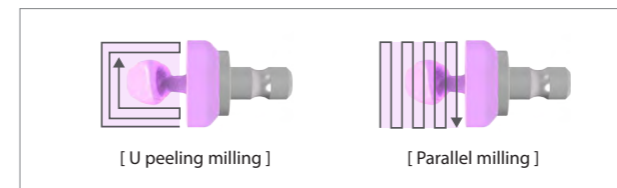

Excellent detail expression

Through groove, labial side texture precision processing using ARUM's exclusive 0.3mm tool for Zirconia, you can process prostheses close to natural teeth.



RPM
80,000

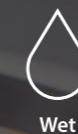

Wet

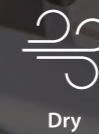

Dry



Labial



Zirconia

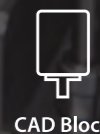

CAD Block



5Axis



Zirconia Crown



Zirconia Hybrid Abutment



Crown & Coping Bridge

Materials & Applications Info.

Materials		Applications	
Pre-milled Blank (Titanium)	X	Implant Bar	X
Co-Cr & Ni-Cr Disk	X	Screw-Retained Bridge (Crown & Coping)	X
Titanium Disk	X	Customized Abutment	X
Lithium Disilicate	⊙	Hybrid Abutment	⊙
Nanocomposite	⊙	Inlay & Onlay	⊙
Zirconia	⊙	Crown & Coping	⊙
PMMA	⊙	Crown & Coping Bridge	⊙
PEEK	⊙	Model	⊙
Wax	⊙	Bite Splint	⊙
		Denture	⊙

⊙: High Compatibility / O: Compatibility / X: Non-Compatibility

Specifications

Axis	5-Axis	Drive Mechanism	Ball Screw
Processing	Wet and Dry	Way System	Linear Guide
Spindle Power	AC 0.5kw	Machine Size (W*D*H)	570*620*640mm
Max. RPM	80,000	Total Size (W*D*H)	570*620*1580mm
A.T.C	12	Weight (Machine / Table)	90kg / 65kg
Tool Shank (mm)	Ø4	Travel	X,Y,Z axis
Motor	Stepping		A / B axis
			±30° / 360°

Tool List

	Code	Size	Code	Size
	Basic	ZB-46	D2*L18*50	PB-51
ZB-47		D1.0*L16*50	DG-52	D2.5*L13*44.5
ZB-48		D0.6*L10*45	DG-53	D1.5*L10*44.5
ZB-65		D0.3*L10*45	DG-54	D1.0*L10*44.5
PB-49		D2*L18*50	DG-55	D0.6*L8*41
PB-50		D1.5*L14*47		
Special	Code	Size	Code	Size
	MOB-56	D3.0*L20*50	ZF-75	D0.6*L8*45
	ZF-70	D1.7*L18*50	TC-80	D1.8*L08*45

Accessories



Disk Cartridge (C-Type)

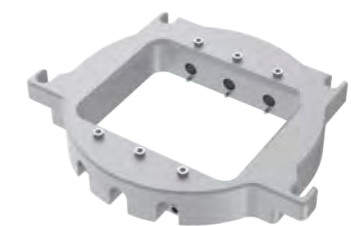

CAD Block Cartridge

* Products are subject to change without notice to improve quality, function, design or otherwise.

ARUM 5X-300D

Looks Like Compact But Not Compact



Zirconia	PMMA
Resin	Wax



Efficient C-TYPE Cartridge
With use of open C type cartridge, you can precisely machine Labial Side (Buccal Side) and Under-Cut zone that requires additional machining.

Excellent detail expression

Every patient wants a prosthesis that looks natural. With milling the grooved part precisely using ARUM's 0.3mm tool for Zirconia, you can reproduce the teeth that look natural teeth.

RPM 60,000	Dry	Labial	Zirconia	CAD Block	5Axis
----------------------	-----	--------	----------	-----------	-------

Materials & Applications Info.

Materials		Applications	
Lithium Disilicate	X	Hybrid Abutment	⊙
Nanocomposite	⊙	Inlay & Onlay	⊙
Zirconia	⊙	Crown & Coping	⊙
PMMA	⊙	Crown & Coping Bridge	⊙
PEEK	⊙	Model	⊙
Wax	⊙	Bite Splint	⊙

⊙: High Compatibility / ○: Compatibility / X: Non-Compatibility

Specifications

Axis	5-Axis	Drive Mechanism	Ball Screw
Processing	Dry	Way System	Linear Guide
Spindle Power	AC 0.5kw	Machine Size (W*D*H)	570*620*640mm
Max. RPM	60,000	Weight (Machine)	90kg
A.T.C	12	Travel	X,Y,Z axis
Tool Shank (mm)	Ø4		A / B axis
Motor	Stepping		±30° / 360°

Tool List

	Code	Size	Code	Size
Basic	ZB-46	D2*L18*50	PB-51	D1.0*L10*44
	ZB-47	D1.0*L16*50	DG-52	D2.5*L13*44.5
	ZB-48	D0.6*L10*45	DG-53	D1.5*L10*44.5
	ZB-65	D0.3*L10*45	DG-54	D1.0*L10*44.5
	PB-49	D2*L18*50	DG-55	D0.6*L8*41
	PB-50	D1.5*L14*47		
Special	Code	Size	Code	Size
	MOB-56	D3.0*L20*50	ZF-75	D0.6*L8*45
	ZF-70	D1.7*L18*50	TC-80	D1.8*L08*45

Accessories

Disk Cartridge (C-Type)	CAD Block Cartridge

* Products are subject to change without notice to improve quality, function, design or otherwise.

ApexMill

The Easy, The Fast, The Accurate

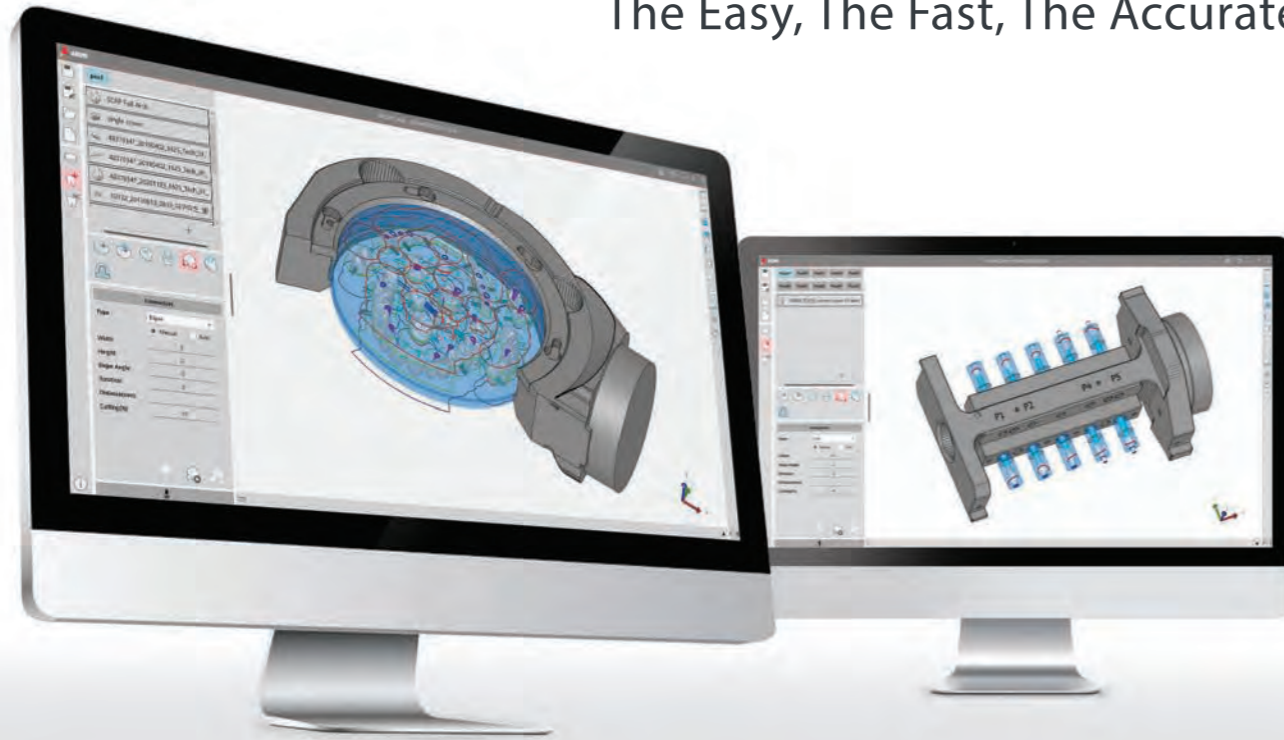

ApexMill is software in which all the machining know-hows of ARUM DENTISTRY are integrated. It is, above all, optimized for ARUM Milling Machine, and guarantees excellent machining quality. It provides a UI/UX environment that is easy for everyone to understand and all the core functions necessary for dental part machining. Now you can experience the most practical and most powerful CAM Design developed by ARUM DENTISTRY.

Function	Description
Implant library machining	A function to easily machine the abutment implant interface with a variety of predefined libraries
Angled screw channel machining	A function to adjust the interface angle and machine angled screw channel
Screw channel machining	A function to paper the screw channel's inner shape / automatically analyze and machine End Type
Grinding machining module	Grinding optimized for lithium disilicate (glass ceramic)
Basic shape recognition	A function of automatic/manual recognition while working on margins and holes even without CAD information
Advanced shape recognition	Differentiated part recognition and modification
Workflow and UI	Practical and intuitive user interface and experience
Material information setting	A function to register and modify materials and to modify basic information modification of each material
Sinter frame creation	A function to create a variety of sinter frames
Toolpath master module	A function to create and modify strategies, define customized machining method and modify machining tool n
Automatic placement	A function to set whether (or not) to use automatic part placement function and specify the degree of overlap.
User-defined area designation	A function to designate and machine a specific area of the prosthesis
Automatic connector	A function to automatically place connectors on part
C-type jig machining	A function to machine thin and long anterior teeth even with thin materials
Machine connection	A function to print out NC output file path as a network folder so that it can be used directly on the machine
Circular material machining	A function to machine the blank of circular material
Block material machining	A function to machine ceramic block material such as lithium disilicate (glass ceramic)
Pre-milled blank material machining	A function to machine the round bar material for abutment
Undercut indication	A function to analyze the undercut for entire part appearance and analyze tooth's inner undercut individually
Simulation history	A function to save and check the recently created list of NC simulation information



Interface Library

With two types of library provided, ie. Straight / Angle, you can machine a wider variety of shapes. By using angle type, you can set the screw channel hole in the direction of lingual surface to produce aesthetically excellent prostheses.

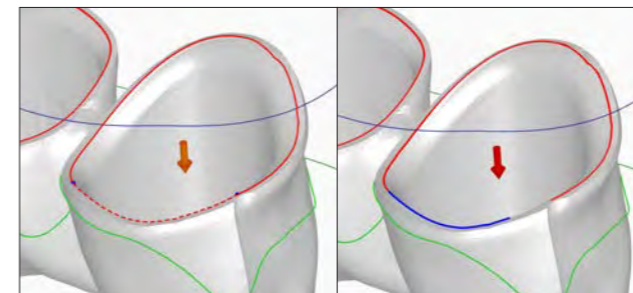
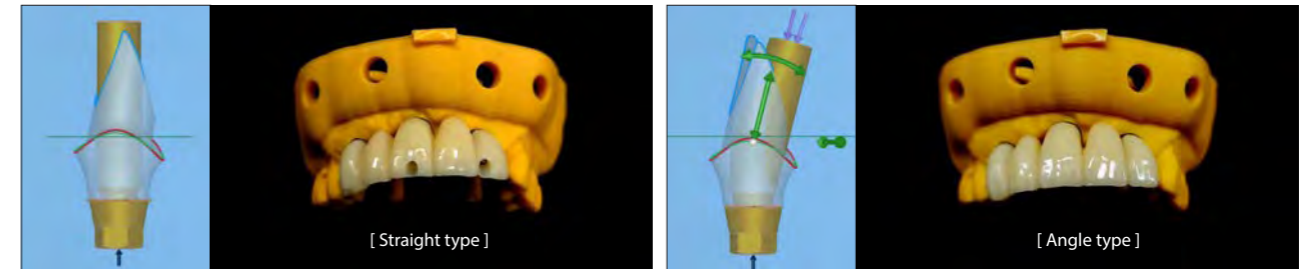

Easy margin line edition

You can delete the margin line requiring modification with just 3 clicks, and create new margin lines in a short time.

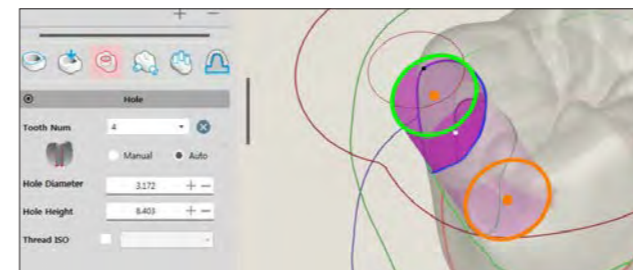

3-point SCR production

You can form SCR hole quickly and easily with 3-point click, and modify the height and diameter of the hole by entering numerical values or using a mouse. In addition, the boundary of the outer shape automatically changes according to the position of the hole, allowing the automatic detection of the possibility of collision between the tool and the material.

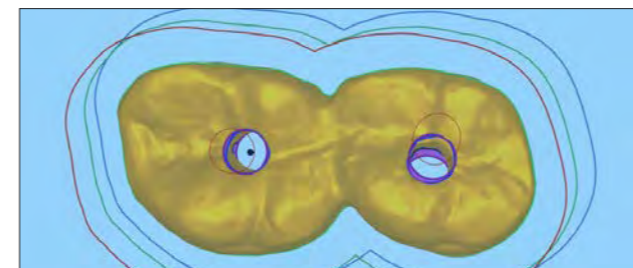

A liberty to change the hole

You can even change the hole for distorted or scanned parts, and freely modify the height, diameter, direction, and position of the hole.

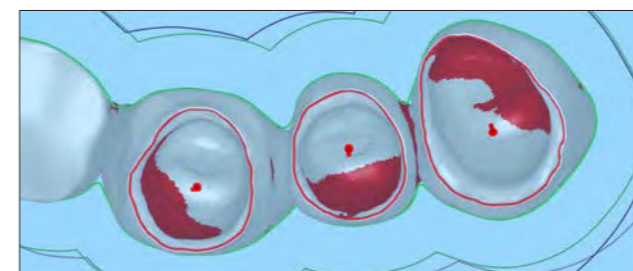

Individual undercut check

You can check the condition of the undercut individually, which allows you to be able to set the insertion direction of the tool faster and more conveniently. In addition, you can easily use the undercut view, the insertion direction modification, view insertion direction, and the occlusal surface machining direction setting using each of the provided icons.

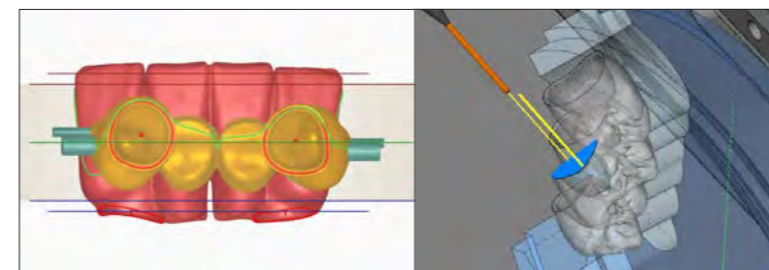

Open C-type jig machining

The use of C-type jig allows you to be able to easily machine thin and long anterior teeth and maximize the application of ApexMill.

Line-up

Line-up		Premium 5X	Premium Eco 5X	ASC Edition	Basic 5X	Basic 4X
Equipment		5X-200 5X-450 5X-500 5X-500L	5X-300 5X-300 Pro 5X-400 5X-450	5X-200 5X-450 5X-500 5X-500L	5X-450 5X-400 5X-300Pro 5X-300	4X-300
Function	Axis	5 Axis	5 Axis	5 Axis	5 Axis	4 Axis
	Nesting	●	●	●	●	●
	Simulation	●	●	●	●	●
	ASC	●	●	●	●	-
	Interface Library	●	●	●	-	-
	Multi Start	●	●	-	-	-
Support	Crown & Coping	●	●	-	●	●
	Inlay, Onlay	●	●	-	●	●
	SCRIP Crown, Hybrid	●	●	-	●	●
	Abutment	●	●	●	●	●
	Barbridge	●	●	●	●	●
	Bitesplint	●	●	-	●	●
	Denture	●	●	-	●	●
	Partial	●	●	-	●	●
	Surgical Guide	●	●	-	●	●

- * Nesting : This feature allows users to arrange parts by rotating, moving, tilting, etc.
- * Simulation : A simulation function to preview the outcome of NC creation
- * ASC : This stands for Angled Screw Channel and allows processing of angled interfaces.
- * Interface Library : A library function to attach an interface to the abutment
- * Multi Start : This is a function that enables users to run multiple programs simultaneously.

Computer Recommended Specifications

Division	Recommended Specifications	*Minimum Specifications
Operating System	Windows 10x64	Windows 7x64
CPU	Intel 3.6 GHz	Intel 1.3 GHz
Graphics Card (VRAM)	Nvidia (6GB)	128 MB
RAM	32 GB	8 GB
HDD	1 TB	250 GB

* Program can be operated normally, but there may be limitations when some high-performance features are required.

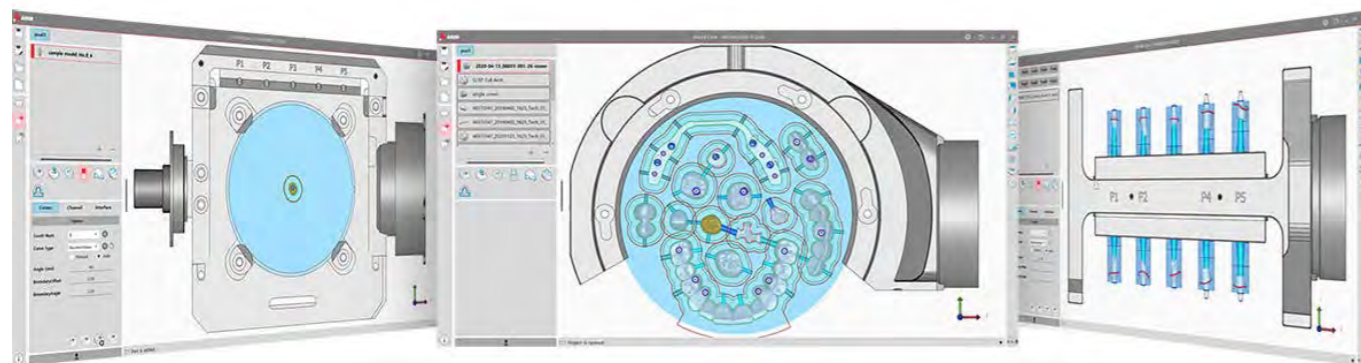

Milling Sample of ApexMill Design



Angled Screw Channel Milling



Straight Screw Channel Milling



Customized Abutment & SCRIP Milling



Crown Bridge & Implant Bar Bridge Milling



Customized Abutment Milling



ARUM 3D Printer System

ARUM 3D Printer (LCD type)

- Resin tank change is easy
- Simultaneous control of Four 3D Printers
- Easy and quick LCD panel replacement
- Resin mixing function

LCD	6"(2560 x 1620) Monochrome LCD
Build Volume (x/y/z - mm)	115 x 70 x 70
Pixel size (µm)	50
Projection Type	405 nm UV LED Projection
Max Print Speed	45 mm/h
Layer Thickness (µm)	50 ~ 100
Control Software	ARUM 3D Printer UI V1.0.0
Slice Software	CHITUBOX Basic V1.9.0



ARUM UV Curing



- Surface gloss, internal strength, and short curing time
- Curing time that can be customized every minute
- Prevents distortion of output with the Chamber warm-up system
- Uniform and stable light irradiation in all directions with rotary turntable UV LAMP

LED Wavelength (nm)	405
Appropriate operating temperature (°C)	0~50
Maximum curing chamber temperature (°C)	50
Internal Chamber (W×H×D mm)	120×138.5×155
Build plate (ø)	110
Electric Consumption (W)	90
Size (W×H×D)	212×349×277
Weight (kg)	5.5

Curing Time

Resin	Curing Time						Temp.	AVG. Curing Time
	0 min	5 min	10 min	15 min	20 min	30 min		
C&B NFH Hybrid A1							50 °C	10 min
C&B NFH Hybrid A2								20 min
C&B NFH Hybrid A3								30 min

** Able to manufacture more accurate shade when adjusting the curing conditions depending on the user's environment

ARUM 3D Printer Resin



Excellent Biocompatibility



Natural Tooth Similarity



Economical



Open Resin System



Low Viscosity

Product	Indication	Features of Product	Volume
C&B 5.0 Hybrid	Temporary	A material used to make a temporary prosthesis, which replaces a natural tooth during a prosthetic treatment and procedure.	1kg, 500g
SG 5.0 (Surgical Guide)	Implant Surgical Guide	A material used to guide the location, direction, and depth of dental implant procedures	
Denture Plus ARUM 5.0	Denture	A material that creates a denture base through photopolymerization	
ARUM MODEL / MODEL ARUM 5.1	Model	A material used to make an oral model for an accurate prosthesis	

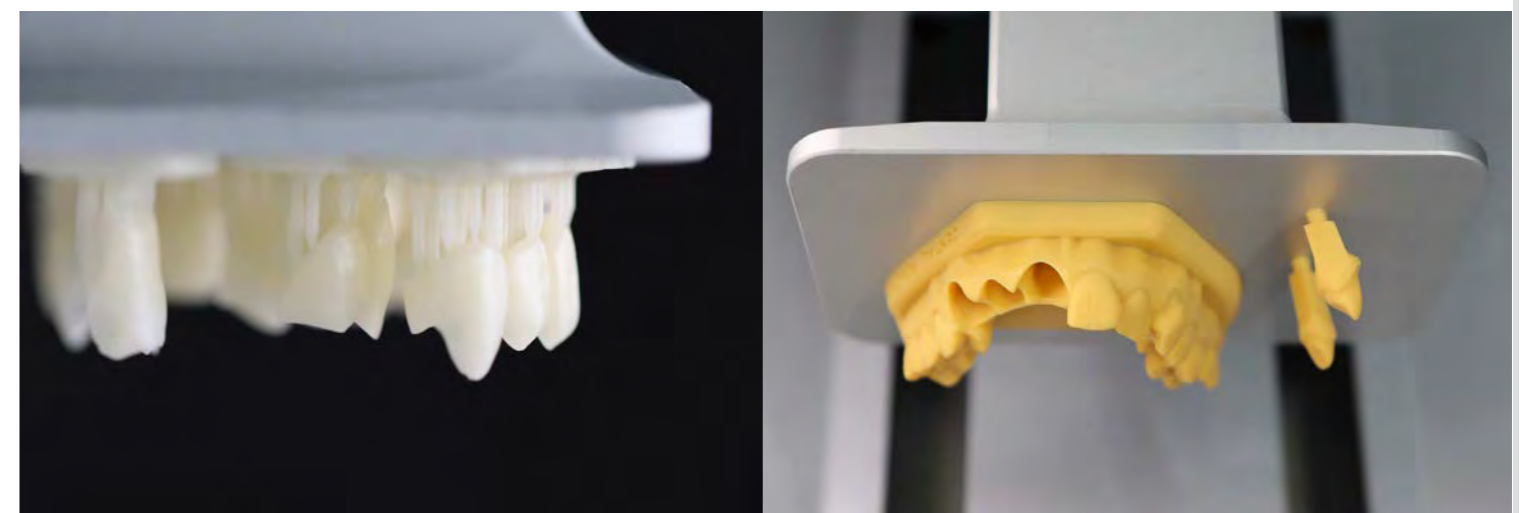

Zirconia Block

ARENA

Play Aesthetic Athletics

- Stable strength and shrinkage rate
- Excellent transparency and aesthetics
- Easy and simple coloring
- Quality control through thorough inspection
- 100% raw materials used by Tosoh

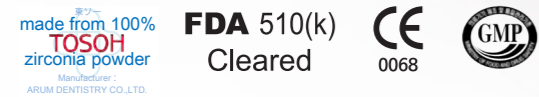

SEM Image (Sintered Body Microstructure)

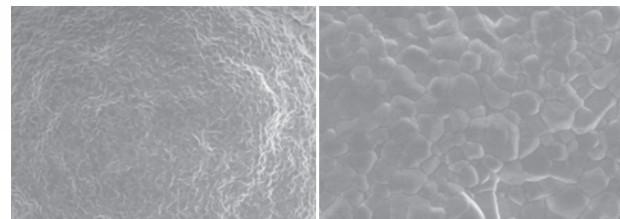

x 5,000

x 20,000

Superior Aging Properties

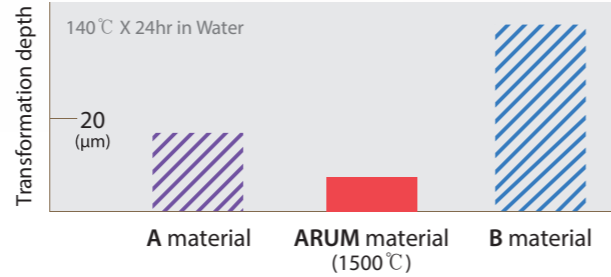

Product Line-up

Product	Type	Shade	Strength (MPa)	Thickness(mm)	Diameter(Ø)
ARENA	Pre-shade	A0(white)/A1/A2/A3/A3.5 B1/B2/B3/B4/C1/C2/C3/D2/D3/D4	1,100	10/12/14/16/18 20/22/25/30	98
	Multi-layered	A1/A2/A3/A3.5	600 ~ 800	12/14/16/18 20/22/25	
ARENA Star	Pre-shade	A0(white)/A1/A2/A3/A3.5/A4 B1/B2/B3/B4/C1/C2/C3/D2/D3/D4	1,100	10/12/14/16/18 20/22/25/30	
	Multi-layered	A1/A2/A3/A3.5	600 ~ 1,100	12/14/16/18 20/22/25	

Coloring Liquid

Type	Volume
Dentin	A1, A2, A3, A3.5, A4
	B1, B2, B3, B4
	C1, C2, C3, C4
	D2, D3, D4
Special	Amethyst 1, 2, 3
	Aqua 1, 2, 3
	Sun 1, 2, 3
	Amber 1, 2, 3
	Natural Gray
	Masking
Rose	



- ARENA & ARENA Star Zirconia Block with excellent absorption
- Represents excellent Shade
- Easy to use even for the beginners
- Uniform absorption of liquid particles
- Constant liquid discharge of brush pen type

ARENA & ARENA Star Coloring Liquid Instruction

Type	Color	Image	Detailed Guide	Classification
Dentin	<ul style="list-style-type: none"> ● A1, A2, A3, A3.5, A4 ● B1, B2, B3, B4 ● C1, C2, C3, C4 ● D2, D3, D4 		Select a liquid for each tooth color based on the ARENA or ARENA Star block.	Dentin
Amethyst	<ul style="list-style-type: none"> ● Amethyst 1 ● Amethyst 2 ● Amethyst 3 		Expresses the block's intrinsic saturation close to the achromatic.	Enamel
Aqua	<ul style="list-style-type: none"> ● Aqua 1 ● Aqua 2 ● Aqua 3 		Express Enamel in Incisal/Occlusal. Paint in the same position as Amethyst in the picture.	Translucent Effect
Natural Gray	<ul style="list-style-type: none"> ● Natural Gray 		To highlight the Enamel of Incisal/Occlusal, apply it based on the line angle. Paint it shortly as shown in the picture.	Highlight Effect
Sun	<ul style="list-style-type: none"> ● Sun 1 ● Sun 2 ● Sun 3 		It increases the saturation of cervical/proximal surface/body. Use it depending on the tooth's condition	Saturation by Location
Amber	<ul style="list-style-type: none"> ● Amber 1 ● Amber 2 ● Amber 3 		It increases the saturation of cervical/proximal surface/body. Use it depending on the tooth's condition.	
Rose	<ul style="list-style-type: none"> ● Rose 		Used to express the color of gingiva.	
Masking	<ul style="list-style-type: none"> ○ Masking 		Use to block discolored teeth and implant's color.	Color Blocking

* This may vary depending on the operator's usage.

Materials



CAD Program



CAM Program



Model Scanner



Model	E1	E2	E3	E4	T 710	T 510	T 310	FREEDOM HD	FREEDOM UHD
Resolution of camera	5MP*2	5MP*2	5MP*2	5MP*4	Mono 5MP *4	Mono 5MP *2	Mono 5MP *2	2.0MP	5.0MP
Accuracy (um)	10	10	7	4	4	7	9	7	7
Scan area (mm)					100*73*60			-	-
Size (W*H*Dmm)					505*340*271			300*495*430	300*495*430
Weight (kg)					15			17	17

Sintering Furnace



Model	ARUM sintering furnace	HT-S 2/M Zirkon 120
Max. Temperature (°C)	1600	1,650
Chamber Volume (mm)	90*90*65	Ø120*30
Size (W*H*Dmm)	375*490*385	390*790*500
Weight (kg)	33	60

Dust Collector



Model	Renfert SILENT Compact CAM
Size (W*H*Dmm)	245*440*500
Weight (kg)	13

Intraoral Scanbody

- Raw Material Ti 6Al-4V ELI (ASTM F 136) Supplied by Germany
- Accurate tightening indicator "A Line"
- Easy and fast scan data matching
- Minimal gingival pressure and securement of gingiva
- Supports with the industry's largest number of implant systems and libraries



Model Scanbody

- Raw Material Stainless Steel 303F
- Industry's largest library
- Industry's largest implant system compatibility



A Line

Indexes for the accurate fastening of implant fixtures and oral scan bodies and the prevention of the rotation of customized abutments.

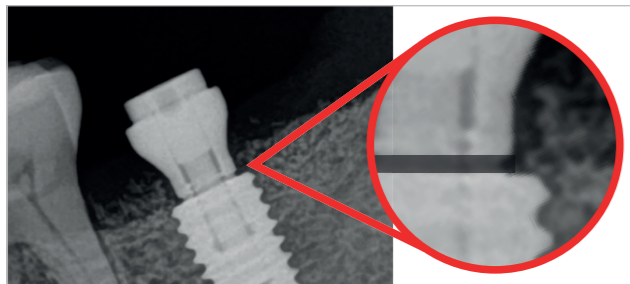

Easy and accurate matching

Easy and accurate scan data and library matching by nuts, D-cut and slope.

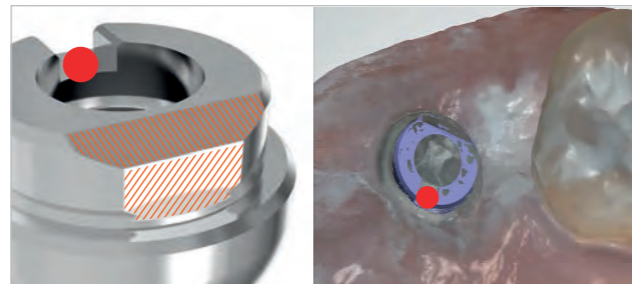

Concave Line

Concave Line to increase the completeness of dental procedure.
Minimization of gingival pressure
Securement of thick gingiva



Intraoral Scanbody Holder

Easy connect to fixture with intraoral scanbody holder
It is good for the complex case like molar procedure.
Possibility to select a suitable size with each different oral cavity

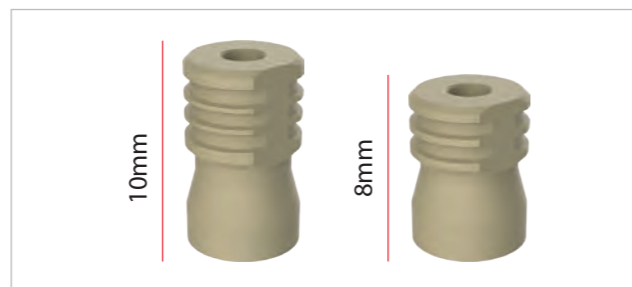

Screw

- Raw Material Ti 6Al-4V ELI (ASTM F 136) Supplied by Germany
- All hand inspection of thread
- Industry's largest implant system compatibility

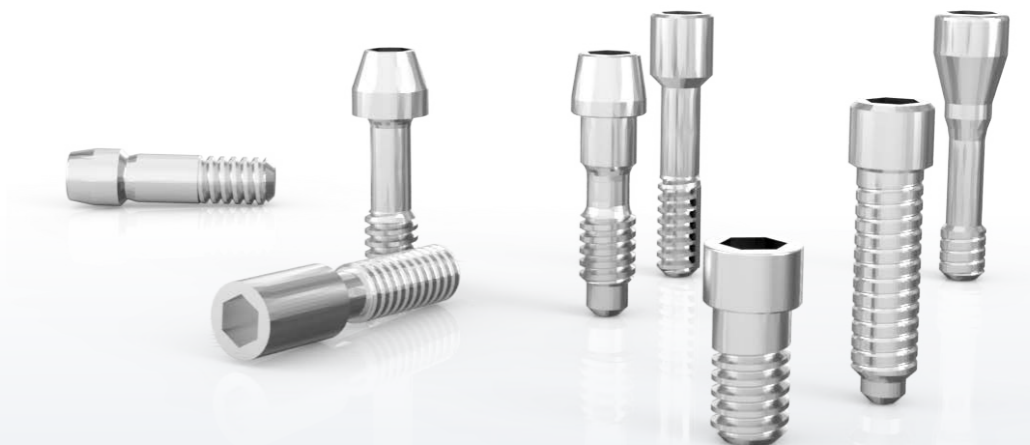

Pre-milled Blank

- Raw Material Ti 6Al-4V ELI (ASTM F 136) Supplied by Germany
- Industry's largest implant system compatibility
- Securement of quality through full-scale inspection
- Precision machined up to $\pm 5\mu\text{m}$



AT Wrench

- Easy to use and storage
- Compatible with all ARUM Attachments
- Stainless Steel 304
- 120mm*30mm*3mm / 76g

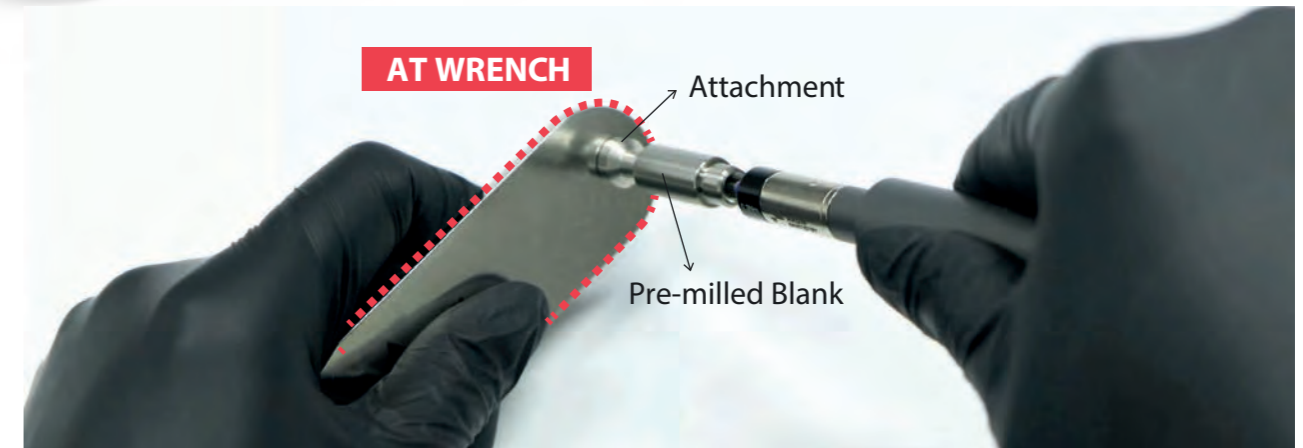

Diameter 10,14mm

We provide diameter of 10 and 14 mm for you to make Customized Abutments appropriate for various conditions of teeth. As they are compatible with more than 500 implant systems, you can machine using ARUM equipment.

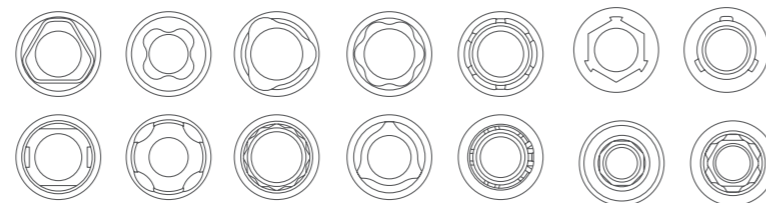

Attachment

With use of Attachment, you can machine more sophisticated and near-perfect Customized Abutment.



Use case

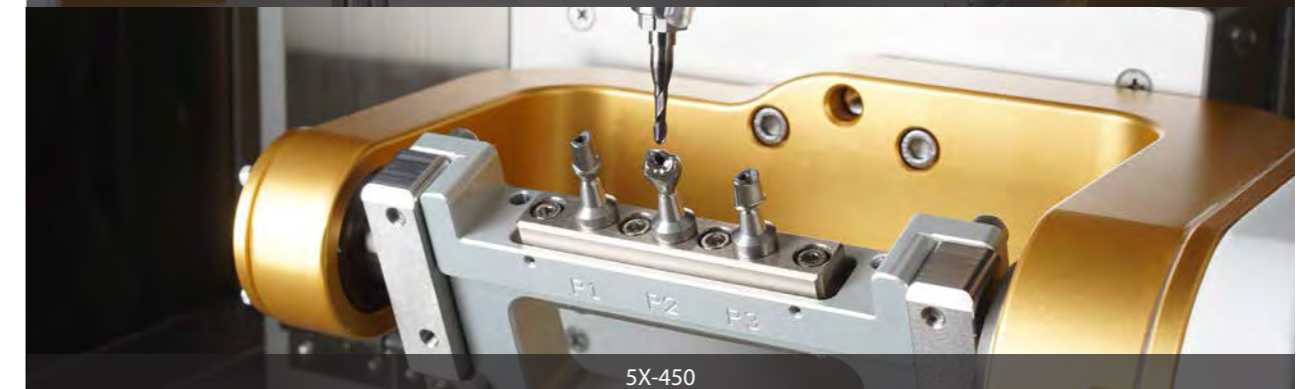

Ti-Base

- Raw Material Ti 6Al-4V ELI (ASTM F 136) Supplied by Germany
- Industry's largest implant system compatibility
- Superior level of biocompatibility
- Combination of high fatigue strength



Analog

- Raw Material Stainless Steel 303F
- Industry's largest implant system compatibility
- Precision machined up to $\pm 5\mu\text{m}$
- For 3D print & stone model

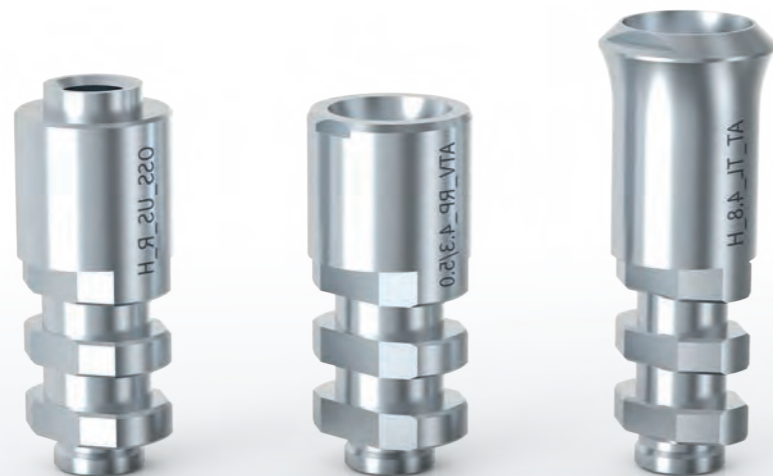

Lab Driver



Screw Driver Tips

- Place the model scanbody and the abutment
- 10 types of tips (compatible with more than 300 implants system)



Analog Insertion Tips

- Place the lab analog to 3D printed model
- Easy and safe to place the lab analog
- Prevent damage of the lab analog internal thread
- 5 types of tips (compatible with more than 300 implants system)













Torque Adapter

- For clamping Attachment and Premill for connectorless milling
- Prevent screw loosening during milling

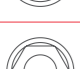

Clinical Driver

Screw Driver Tips Line-Up

SIZE	COLOR	Compatible Implant System
 Hex 1.0	Blue	DENTSPLY Ankylos C/X Implant, etc.
 Hex 1.2	Purple	BIOMET 3i Certain, BIOMET 3i EXTERNAL HEX, DENTIS i-Clean, DENTSPLY Xive, DIO UF, MEGAGEN AnyONE, MEGAGEN Anyridge, NEOBIOTECH, OSSTEM GS(TS), OSSTEM SS, OSSTEM US, SIC Invent, etc.
 Hex 1.25	Black	BEGO Semados, BIOHORIZONS External, BIOHORIZONS Internal, DENTIS s-Clean, LASAK Bioniq, etc.
 Hex 1.27	Red	ALPHABIOTEC Internal Hex, ANTHOGRYR axiom, ASTRA TECH OsseoSpeed TX, CAMLOG, DENTIUM Super-Line, IMPLANT DIRECT Legacy, MIS C1, MIS Internal Hexagon, ZIMMER Tapered Screw-Vent, etc.
 Hex 1.3	Green	ASTRA TECH OsseoSpeed EV, CLC Conic, DYNA Pushin Octalock, KENTEC, PLATON, Type IV Pro, Sweden & Martina, etc.
 Torx 1.7	Brown	STRAUMANN Bone Level, STRAUMANN Conical Bone Level, STRAUMANN synOcta, etc.
 Torx 1.5 (Star)	Yellow	ADIN CLOSEFIT, NOBEL BIOCARE Active, NOBEL BIOCARE Branemark, NOBEL BIOCARE Replace Select, etc.
 Cross	Gray	THOMMEN SPI, etc.
 Ball Torx	Orange	1. Most of angled screws of ARUM Ti-base (screw head size is more than 2.1mm) 2. All implant system for disk angulated screw channels
 Ball Hex	White	Some of angled screws of ARUM Ti-base (screw head size is less than 2.1mm) *Please contact us for a separate list.

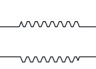
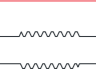
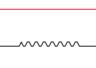
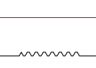
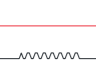

Analog Insertion Tips Line-Up

SIZE	COLOR	Compatible Implant System
 M2.0*P0.40	Cocoa	Osstem GS Regular, Dentium Super line, Megagen Anyone, Dentis S-clean, Straumann Tissue level, etc.
 M1.8*P0.35	Light Green	Zimmer TSV, Megagen Anyridge, Biohorizon Internal, Bego Semados, etc.
 M1.6*P0.35	Pink	Straumann Bone level, Osstem GS Mini, Nobel biocare Active Mini, Dentsply Xive, Neodent GM, etc.
 M1.4*P0.30	Sky Blue	Starumann Bone level 2.9, Dio UF Narrow, Megagen Mini, Astra YellowMost of Multi unit, etc.
 M2.5*P0.45	Ivory	Osstem US Wide, Nobel biocare Branemark WP, etc.







** Aware of the color of analog tip
** Contact us for a complete list of implant compatibility

- Use of Trimrite with excellent corrosion resistance
- Easy and simple cleaning
- For angle screw channels
- Heat treatment and hardness of 50 or more



Size	Length	Order Code	Implant System	Recommend Torque
 Ball Torx	22mm	BT1722	1. Most of angled screws of ARUM Ti-Base (screw head size is more than 2.1mm) 2. All implant system for disk angulated screw channels	20 Ncm
	15mm	BT1715		
	8mm	BT1708		
 Ball Hex	22mm	BH1222	Some of angled screws of ARUM Ti-Base (screw head size is less than 2.1mm) *Please contact us for a separate list.	20 Ncm
	15mm	BH1215		
	8mm	BH1208		

Consumable Line-up

ARUM Product List													
No	ARUM System	Compatibility Implant System	Screw	Analog	Ti-Base		Model Scanbody	Intraoral Scanbody	Pre-milled Blank 10mm		Pre-milled Blank 14mm		Attach
					H	NH			H	NH			
50	MEG	MEGAGEN®	○	○	○	○	○		○		○		
51	MEG-ONE	MEGAGEN® AnyONE	○	○	○	○	○	○	○	○	○	○	○
52	MEG-RID	MEGAGEN® Anyridge®	○	○	○	○	○		○	○	○		○
53	MEG-EEP	MEGAGEN® Anyridge® Extra EZ POST	○				○		○	○			
54	MEG-EZP	MEGAGEN® EZ Plus	○	○	○	○	○		○	○	○	○	○
55	MEG-RES	MEGAGEN® Rescue	○	○	○	○	○		○	○	○	○	○
56	MS-C	MIS® C1	○	○	○	○	○		○				○
57	MS-INT	MIS® Internal Hexagon	○	○	○		○	○		○			○
58	NEB	NEOBIOTECH®	○	○	○	○	○	○	○	○	○		
59	NED	NEODENT® CM Implant Line	○	○	○		○		○				
60	NED-GM	NEODENT® GM	○	○	○	○	○	○					○
61	NOS-PA	NEOSS Pro Active®	○	○	○	○	○		○		○		○
62	NB-ACT	NOBEL BIO CARE® Active™	○	○	○	○	○	○		○			○
63	NB-BRA	NOBEL BIO CARE® Branemark®	○	○	○	○	○		○		○		○
64	NB-REP	NOBEL BIO CARE® Replace Select™	○	○	○	○	○		○		○		○
65	NCOS	NucleOSS	○		○		○		○				
66	OST-GS	OSSTEM® GS(TS)	○	○	○	○	○	○	○	○	○	○	○
67	OST-SS	OSSTEM® SS	○	○	○	○	○		○	○	○		○
68	OST-US	OSSTEM® US	○	○	○	○	○	○		○			○
69	PLT-IV	PLATON® Type IV Pro	○				○		○				
70	SHN	SHINHUNG®	○	○			○		○				
71	SC-INV	SIC Invent®	○	○	○		○		○		○		○
72	SI-MSC	SOUTHERN IMPLANT MSc EXTERNAL HEX	○	○	○	○	○		○	○			
73	SI-INT	SOUTHERN IMPLANTS M-Series (Internal Hex)	○	○			○						
74	STR-BL	STRAUMANN® Bone Level®	○	○	○	○	○	○	○	○			○

ARUM Product List													
No	ARUM System	Compatibility Implant System	Screw	Analog	Ti-Base		Model Scanbody	Intraoral Scanbody	Pre-milled Blank 10mm		Pre-milled Blank 14mm		Attach
					H	NH			H	NH			
75	STR-CBL	STRAUMANN® Conical Bone Level®	○	○	○	○	○		○	○			
76	STR-TL	STRAUMANN® synOcta®	○	○	○	○	○		○	○	○	○	
77	SM	Swedn&Martina	○	○	○		○		○				○
78	THO-SPI	THOMMEN SPI®	○	○	○		○		○		○		○
79	WAR-ONE	WARANTEC® Oneplant	○	○	○	○	○		○		○		
80	ZMR	ZIMMER®	○	○	○	○	○		○		○	○	○
81	ZMR-SPA	ZIMMER® Spline A	○	○			○		○				
82	ZMR-SPB	ZIMMER® Spline B	○	○		○	○		○		○		
83	ZMR-TSV	ZIMMER® Tapered Screw-Vent®	○	○	○	○	○	○	○	○	○	○	○

* Products are subject to change without notice to improve quality, function, design or otherwise.

www.arumdentistry.com



ARUM DENTISTRY Co., Ltd.

23, Gukjegwahak 11-ro, Yuseong-gu, Daejeon, 34002, Republic of Korea
Tel +82 42 935 3644 | Fax +82 42 935 3645 | www.arumdentistry.com
Contact info@arumdentistry.com

